

# ALPS BA5.2 lithium battery: a quick start guide

## Components

1. Earth point
2. Battery pack (negative terminal)
3. Battery on/off switch
4. Charge indicator
5. DIP switch
6. RS232 6P
7. Inverter CAN 8P
8. Inverter RS485 8P
9. Battery RS485 8P
10. Battery pack (positive terminal)
1. **Battery on:** Press and hold the battery switch for 1s. The buzzer will sound for 2s and the battery switch LED will illuminate.
2. **Battery off:** Press and hold the battery switch for 3s. The buzzer will sound for 1s and the battery switch LED will go off.

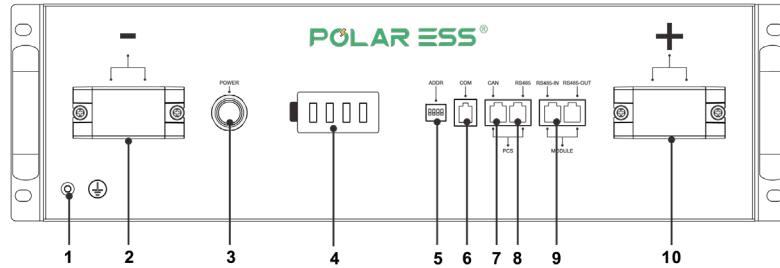

## Dimensions

Note: Handles are optional

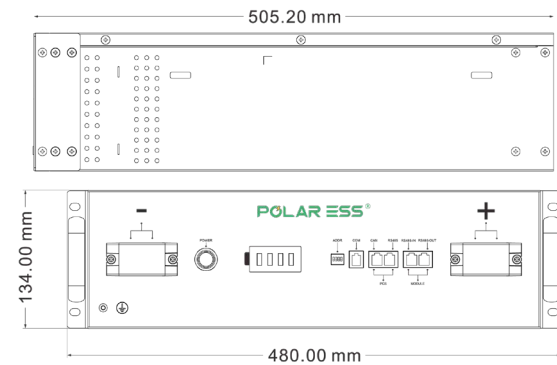

## Environment

**Temperature**  
0°C - 50°C

**Humidity**  
5% ~ 85%

**Indoor installation only**

1. The battery can be installed in a standard 19" cabinet or rack. Indoor installation requires adequate ventilation all around the system without obstacles. Handles are required for rack mount option.
2. The battery should be installed by a qualified electrician. Any future maintenance or updates should also be completed by a qualified electrician.
3. If the battery seems to be damaged, pack it in its original container and return it based on the terms laid as per distributor guidelines.

## System overview

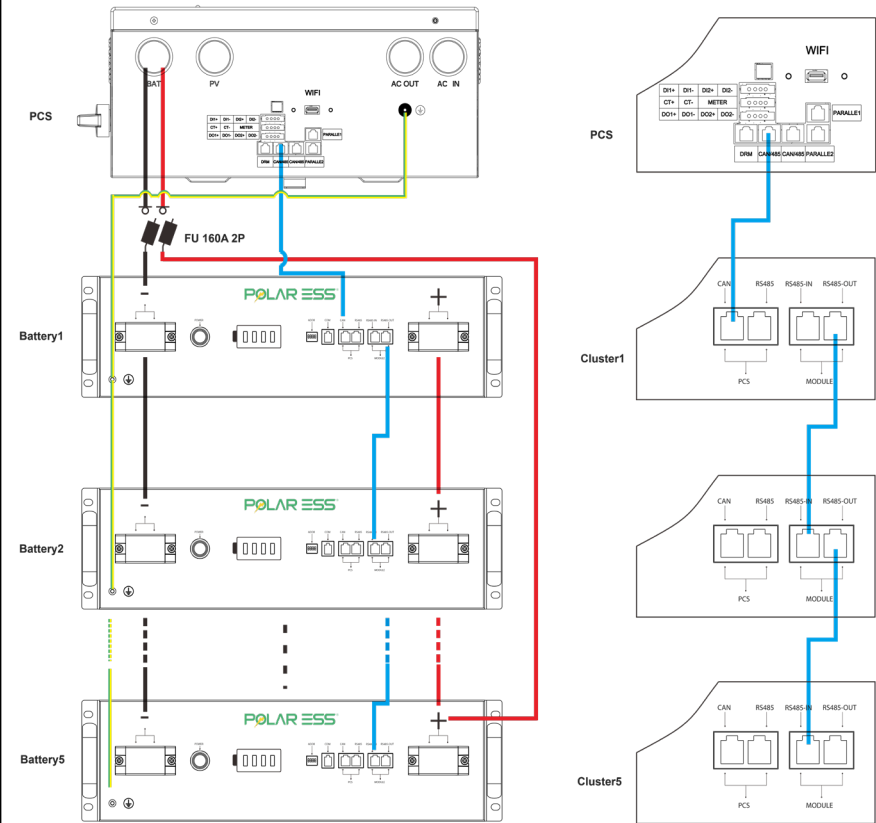

## Install

1. Install with bracket:  
**Note:** Foot support accessories are optional

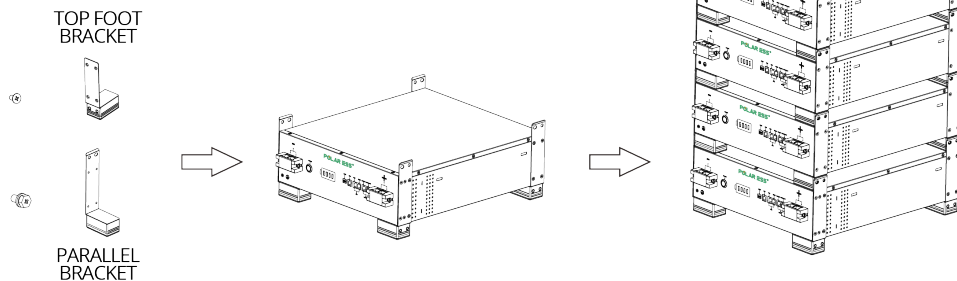

2. Install in standard cabinet or rack:  
**Note:** 19" standard cabinet is optional

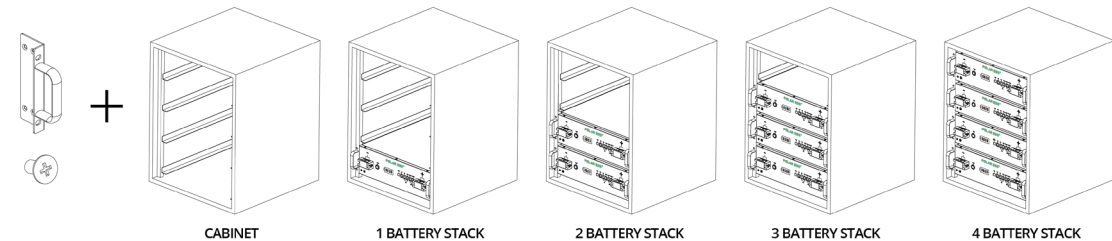

# ALPS BA5.2 lithium battery: a quick start guide

Battery parallel ID		<i>Note: Switch in up position is 0</i>
Battery	ID	Description
Master		0,0,0,0
Slave 1		1,0,0,0
Slave 2		0,1,0,0
Slave 3		0,0,1,0
Slave 4		0,0,0,1

Battery to battery cables			<i>Note: Battery to battery cables are only necessary in multi-battery installations</i>
No.	Type	Description	
1	Battery to battery power cables	3AWG black cable 3AWG red cable Length: 185mm	
2	Earth point cable	10AWG yellow-green cable Length: 200mm	
3	Battery to battery communication cable	Cable with 8P8C RJ45 Length: 300mm	

LED status description		
No.	LED	Status
1	OFF	Shut down
2	Green	Steady: Battery on Blinking: Charging or discharging
3	Red	Battery in fault status
4	Twinkling	Upgrading status

Battery to inverter cables		
No.	Type	Description
1	Battery to inverter power cables	3AWG black cable 3AWG red cable Length: 2000mm
2	Battery to inverter communication cable	Cable with 8P8C RJ45 Length: 2000mm

## Warnings

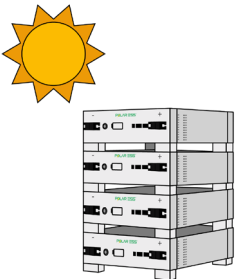

Keep away from heat sources or naked flame



In the event of fire, don't use water. Use dry powder or a carbon dioxide fire extinguisher.

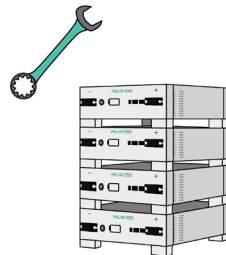

If the battery is damaged, please contact Polar ESS or your wholesaler for help as soon as possible.



Please refrain from disposing batteries in general waste – specialised disposal methods should be used.